

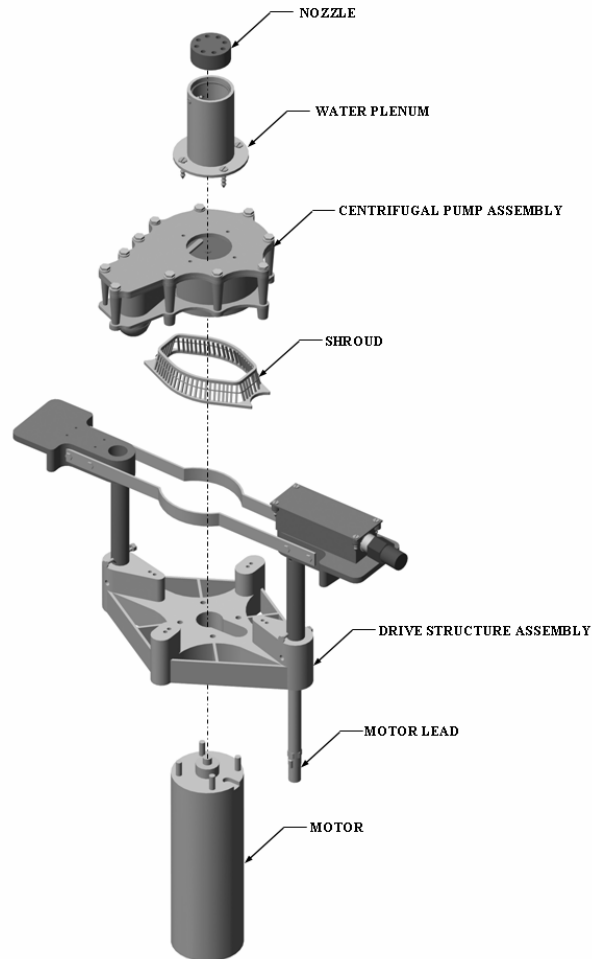

PLATINUM CENTRIFUGAL PUMP DRIVE STRUCTURE OR MOTOR REPLACEMENT



!WARNING: RISK OF ELECTRIC SHOCK, DISCONNECT POWER PRIOR TO SERVICING

STEP 1 Place the fountain upright with the motor resting on a stable surface. CAUTION: Do not allow the unit to fall over as damage may occur.

STEP 2 Remove the water plenum, nozzle assembly and gasket by removing the four 1/4-20 hex head cap screws from the flange of the water plenum.

STEP 3 Remove the four 1/4-20 hex head cap screws that attach the pump to the motor mount. Remove the pump by pulling upward with a rocking motion to remove the pump from the motor

- STEP 4 Remove shroud and clean all debris from the motor mount and motor shaft.
- STEP 5 Remove the four screws from the junction box lid and remove lid.
- STEP 6 Remove the four wire nuts that attach the motor lead to the male disconnect and discard.
- STEP 7 Remove the two screws from the motor lead cover located on the bottom side of the motor mount, exposing the motor lead wire.
- STEP 8 Pull the motor lead wires out of the support tube.
- STEP 9 Remove the four nuts and washers that attach the motor to the mount and lift the drive structure assembly off of the motor.
- STEP 10 Insert motor lead wires through the support tube and into the junction box
- STEP 11 Reinstall the motor lead cover located on the bottom side of the motor mount.
- STEP 12 Install the new or original drive structure assembly to the replacement motor or the original motor.
- STEP 13 Connect the motor lead wires to the male disconnect using new silicone filled wire nuts.
- STEP 14 Reinstall the junction box lid.
- STEP 15 Reinstall the water plenum, impeller, shroud and nozzle assembly. Insure flow straightner is installed and impeller turns freely.