

CENTRIFUGAL PUMP MOTOR MOUNT, MOTOR AND WIRE ASSEMBLY REPLACEMENT

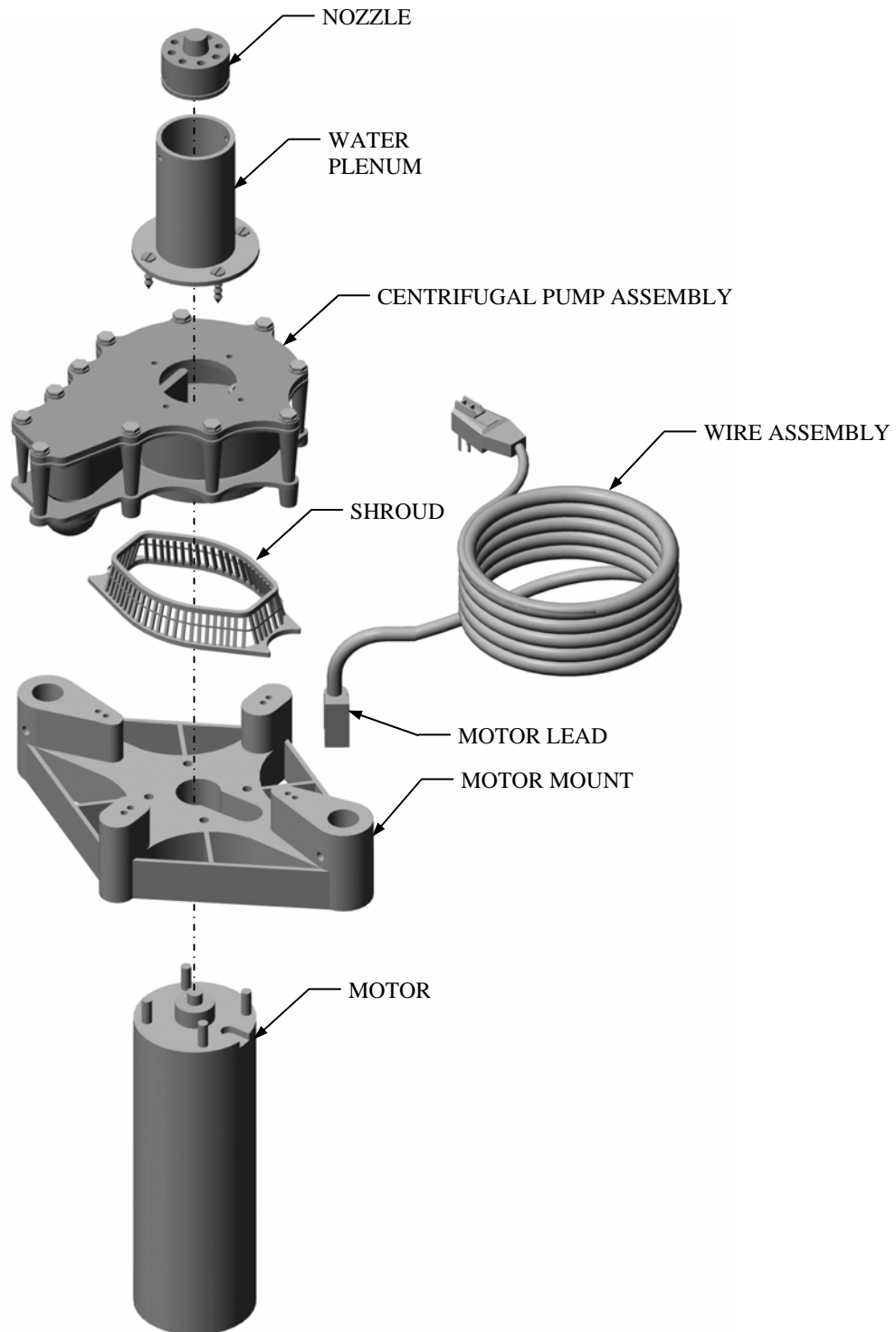

!WARNING: RISK OF ELECTRIC SHOCK, DISCONNECT POWER PRIOR TO SERVICING

STEP 1 Place the fountain upright with the motor resting on a stable surface. CAUTION: Do not allow the unit to fall over as damage may occur.

STEP 2 Remove the water plenum, nozzle assembly and gasket by removing the four 1/4-20 hex head cap screws from the flange of the water plenum.

STEP 3 Remove the four 1/4-20 hex head cap screws that attach the pump to the motor mount. Remove the pump by pulling upward with a rocking motion to remove the pump from the motor

STEP 4 Remove shroud and clean all debris from the motor mount and motor shaft.

STEP 5 Remove the four nuts and washers that attach the motor to the motor mount and lift the motor mount off of the motor.

STEP 6 Loosen the jam nut that attaches the wire assembly to the motor with a 3/4" open end wrench. Once the jam nut is loosened from the motor, pull upward on the wire assembly and remove from the motor.

STEP 7 Install new motor mount to the motor by first installing the wire assembly into the motor. It is strongly recommended to apply dielectric grease to the wire harness plug to help with the installation.

STEP 8 Reinstall shroud, pump, water plenum and nozzle assembly in reverse order from removal.